

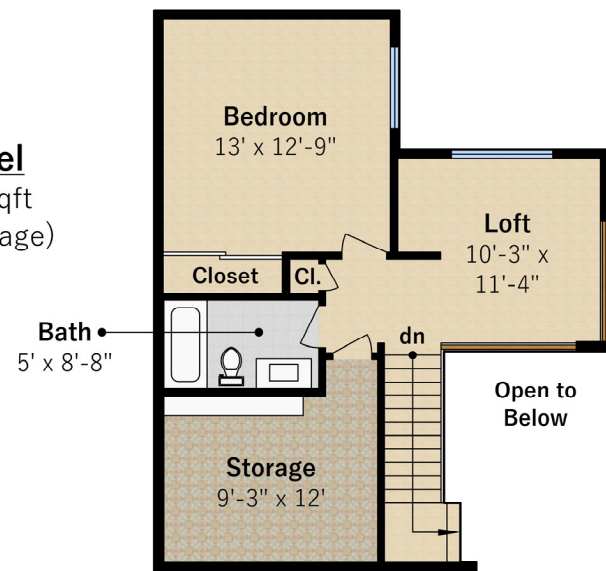

1395 Candelero Drive

Walnut Creek, CA 94598

Upper Level
approx. 412 sqft
(+110 sqft Storage)



**Estimated Total Finished
Square Footage: 1,520 sqft**
Main Level: 1,108 sqft
Upper Level: 412 sqft

**Estimated Total Unfinished
Square Footage: 548 sqft**
Garage: 438 sqft
Upper Storage: 110 sqft

Interior room dimensions are shown, but all square footage is calculated from the outside perimeter of exterior walls. Balconies, porches, and patios are not included in calculations.
Measured on July 25th, 2024



Main Level
approx. 1,108 sqft
(+438 sqft Garage)

Any and all information on this drawing is for illustrative purposes only and is deemed reliable, but not guaranteed. All information requires independent verification.

Listed By: Ken Jacobs
Clocktower Realty | www.cloctowerrealty.com



All Material presented herein is intended for informational purposes only. Information is compiled from sources deemed reliable but has not been verified. No Statement is made as to the accuracy of any description. All measurements and square footages are approximate. Exact dimensions can be obtained by retaining the services of an architect or engineer.

1395 Candelero Dr., Walnut Creek

2 Bedrooms + Loft | 2 Baths | 1500 Sq Ft. | Listed for \$825,000



Gorgeous Renovated Townhouse in Outstanding Location

As you step inside this stunning townhome, you're immediately greeted by designer lighting fixtures, vaulted ceilings, and luxurious walnut engineered hardwood flooring. The expansive living area features a bar area with a built-in wine fridge, a cozy fireplace, a ceiling fan, plantation shutters, and a dining area that overlooks the private rear patio.

Conveniently located on the main level, the primary bedroom suite boasts a renovated bathroom with a tiled shower, a dark wood vanity with double sinks, and a quartz countertop with modern fixtures and finishes. The spacious kitchen has been beautifully upgraded with maple cabinetry, a pro-style KitchenAid gas range, under-cabinet lighting, an included LG refrigerator, and a convenient center island. A two car attached garage opens to the kitchen and has an included washer/dryer.

Upstairs, you'll find a bedroom with vaulted ceilings and a bathroom that has been stylishly updated with a modern vanity, lighting, and tile flooring. A loft area overlooking the living room provides the perfect space for a home office and could also be converted to a 3rd bedroom. A finished, walk-in attic area off the upstairs hallway offers abundant storage options.

Incredible location with easy access to the freeway, BART, the canal trail, Heather Farms Park, and Countrywood Shopping Center. The HOA amenities include a pool, tennis courts and greenbelt area.



Ken Jacobs
Broker/Owner
925.280.1260
ken@ClocktowerRealty.com
DRE # 01242343



Ken Broz
Broker Associate
925.465.5181
ken@kenbroz.com
DRE # 01359600





- 2 bedrooms + Loft, 2 baths, approximately 1500sq ft (according to public records)
- Living area with hardwood flooring, vaulted ceilings, fireplace and dining area
- Kitchen includes maple cabinetry, solid surface counters and upscale stainless steel appliances.
- Primary suite on main level has a beautiful renovated bath with tile shower
- Private rear patio
- Two car attached garage
- Included refrigerator & washer/dryer
- Convenient to BART and freeway access, canal trail, Heather Farms Park and Countrywood Shopping Center.
- HOA features include a community pool, tennis courts and greenbelt area.
- Highly rated Walnut Creek schools include Bancroft Elementary, Foothill Middle School and Northgate High School (please verify availability w/school district)
- HOA Dues \$476 monthly

Offered at \$825,000



www.1395CandeleroDr.com

